

REVISIONS				
REV.	ZONE	DESCRIPTION	DATE	INITIAL
1	7D	ADDED NOTE 1.	04/16/15	M.S.

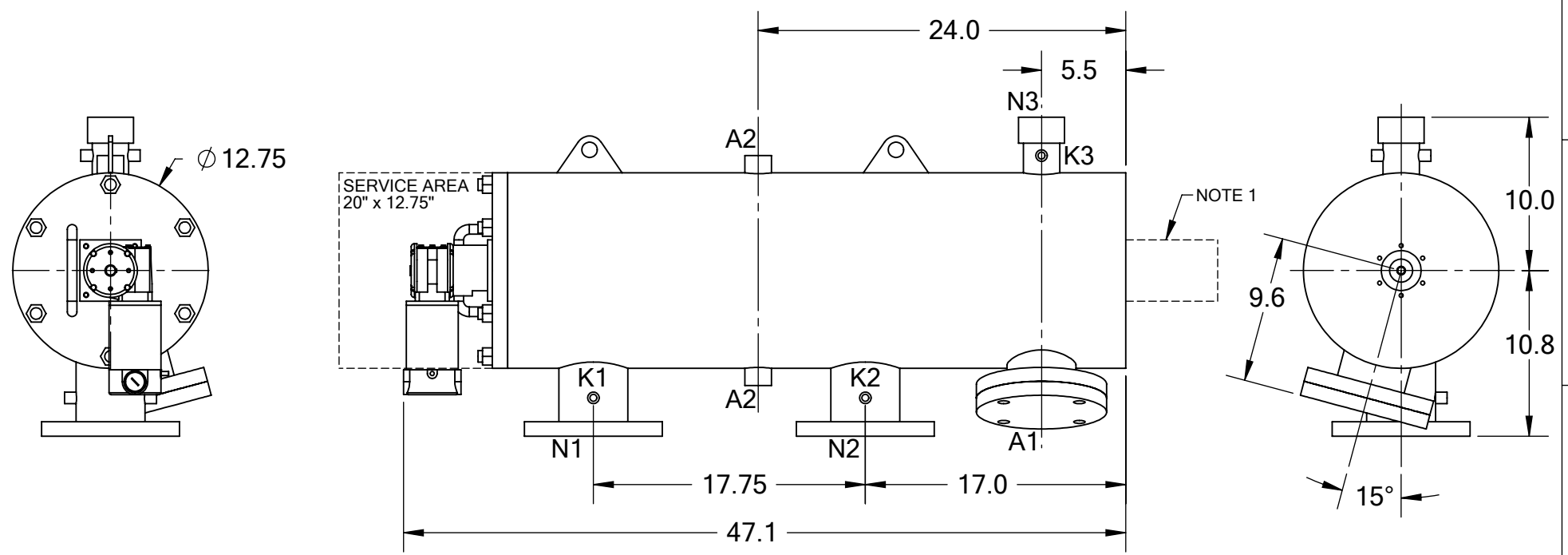

TECHNICAL DATA

FLOW RATE	MAX. 400 GPM (91 m ³ /hr)
SCREEN SIZE	___ MICRON
SCREEN AREA	2.5 SQ. FEET
DESIGN TEMPERATURE	160 °F
DESIGN PRESSURE	150 PSI
EMPTY WEIGHT	~250 LBS.
FULL WEIGHT	~450 LBS.

NOTES:
 1. PLEASE ALLOW ~20" ADDITIONAL TO INSTALL AND REMOVE THE PISTON ASSEMBLY TO THE BACKSIDE OF THE FILTER.

NOZZLE	CONNECTION	TYPE	SIZE	RATING	TOLERANCES (UNLESS OTHERWISE SPECIFIED)	 2672 S. LA CIENEGA BLVD. LOS ANGELES, CA 90034 MAIN: (310) 839-2828 FAX: (310) 839-6878
A1	SERVICE PORT	FLANGED	3.5" ASA	CL. #150 F.F. w/ Blind	FRAC. ±1/16	
A2	PRESSURE RELEASE	THREADED	1" NPT(2)		ANGLE ±1°	
K1	HIGH PRESSURE CONN.	THREADED	1/4" NPT(2)		.X ±.1	MATERIAL: SST
K2	LOW PRESSURE CONN.	THREADED	1/4" NPT(2)		.XX ±.05	
K3	HYDRAULIC CONN.	THREADED	1/4" NPT(2)		.XXX ±.010	TITLE: LPF4-LPE FILTER, CUT DRAWING
N1	INLET	FLANGED	4" ASA	CLASS #150 F.F.S.O.		
N2	OUTLET	FLANGED	4" ASA	CLASS #150 F.F.S.O.		DRAWN BY: S. PERKINSON
N3	FLUSH OUTLET	THREADED	2" NPT			
					DATE: 04/11/12	DRAWING NUMBER REV LPF-4LPE-CUT-01 1
					SCALE: 1:10 SHEET: 1 OF 1	