

REVISIONS				
ZONE	REV	DESCRIPTION	DATE	APPROVED

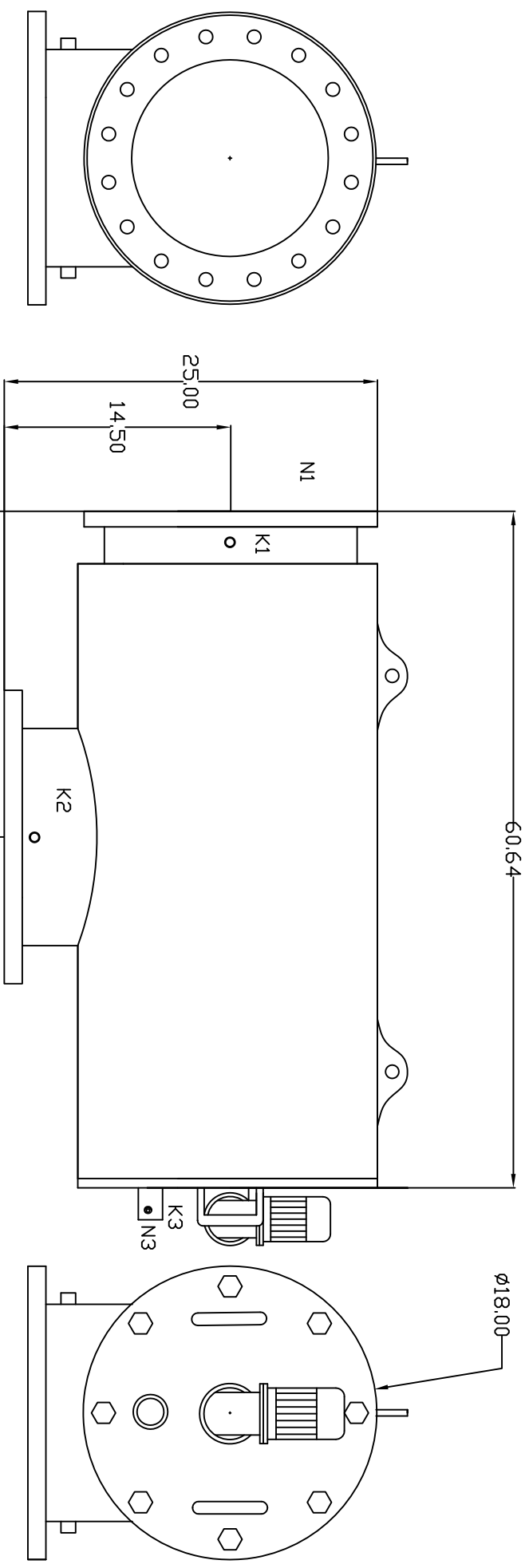

TECHNICAL DATA

Flow Rate Max: 3500 GPM
 Screen Size ----- Micron
 Screen Area 12.5 sq.ft
 Working Temp. 200 deg. F
 Working Pressure 150 PSI
 Empty Weight 800 lbs.
 Full Weight ----- lbs.

NOZZLE	CONNECTION	TYPE OF CONNECTION	SIZE	RATING
K1	Hi. Press. Conn.	Threaded	1/4" NPT(2)	150 lbs. F.F.
K2	Low Press. Conn.	Threaded	1/4" NPT(2)	150 lbs. F.F.
K3	Hydraulic Conn.	Threaded	1/4" NPT(2)	150 lbs. F.F.
N1	Inlet	Flanged	12" ASA	150 lbs. F.F.
N2	Outlet	Flanged	12" ASA	150 lbs. F.F.
N3	Flushoutlet	Threaded	2" NPT	150 lbs. F.F.

UNLESS OTHERWISE SPECIFIED
 DIMENSIONS ARE IN INCHES
 TOLERANCES
 DECIMALS ANGULAR
 .XX ± .05 ± 0.5 DEG.
 .XXX ± .01

AUTOMATIC FILTERS, INC.
 2672 S. LA CIENEGA BLVD.
 LOS ANGELES, CA 90034
 (310) 839-2828 FAX (310) 839-6878

DRAWN	S. Perkinson	DATE	10/18/10
CHECKED			
DESIGN			

TITLE: CSB12-L

SIZE	DWG. NO.	REV
A	CSB12-L	N/A

NPT TD SCALE SHEET 1 OF 1

A

B

C

D

E